

PART FIRST FLOOR PLAN
MEZZANINE OVER OFFICES

GROUND FLOOR PLAN

REVISIONS	
A	03/20/05 Issues to contractor for construction
B	03/25/05 Generally updated as Formula 1 requirements
C	03/25/05 Floor slab and water supply to workshop area indicated
D	10/26/05 Windows adjusted as per plan
E	08/21/05 Updated as shown on 08/19/05
F	12/29/05 General amendments as requested by Building Control Officer
G	12/10/05 Fire Officer comments added

WHEATLEY HALL TRADE PARK
WHEATLEY HALL ROAD
DONCASTER DN2 4PE

SCALE	1:50	A1
Contractor must verify all dimensions on the site before commencing any work or preparing manufacturing drawings.		
DATE	27-05-05	DRAWN BY MS
APPROVED BY	ND	ISSUED TO SITE

HATRELL AND PARTNERS
CHARTERED ARCHITECTS
COVENTRY MANCHESTER

UNIT 3 (FORMULA 1)

ARTHUR HOUSE CHORLTON STREET MANCHESTER M1 3EU
 FACSIMILE 0161 228 3981 TELEPHONE 0161 228 3321
 1 COPTHALL HOUSE STATION SQUARE COVENTRY CV1 2JG
 FACSIMILE 02476 520 460 TELEPHONE 02476 228 446

Founded 1894

1982-111



© This Drawing & Design is the copyright of Jenkins Design Services Ltd and should not be reproduced without written consent.

Contractors are to check all levels & dimensions on site prior to site works commencing & report discrepancies to the Designers.

DO NOT SCALE THIS DRAWING

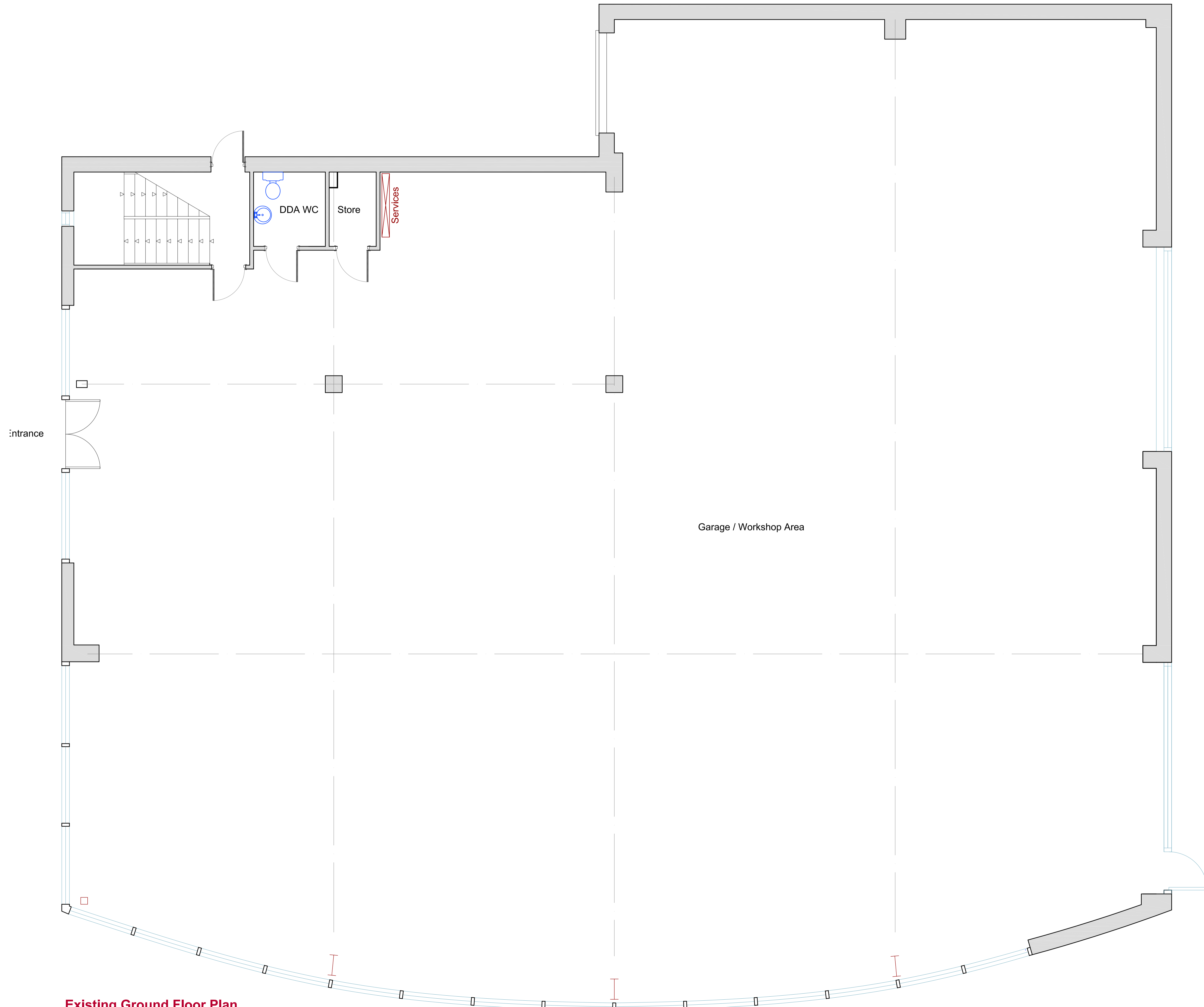

Existing Ground Floor Plan

	rev	description	by	date
Project:		F1 Autocentre Fit Out - CRAWLEY Unit 10, Denvale Trading Park, Haslett Ave. RH10 1SS		
Client:		F1 Autocentres		
Title:		Existing Ground Floor Plan		
Scale:		1:100 @ A3		
Date:		November 2009		
Drawn:		DWL		
Dwg N°:		21036-01		



ARCHITECTURE INTERIOR PROJECT CDM BUILDING
DESIGN MANAGEMENT CO-ORDINATOR CONSULTANCY

JENKINS DESIGN SERVICES LTD
24 HOUGHTON STREET, BURY,
LANSHIRE, GU14 7JF
TEL: 01494 783 772
E: TEAM@JENKINSDESIGN.CO.UK



© This Drawing & Design is the copyright of Jenkins Design Services Ltd and should not be reproduced without written consent.
Contractors are to check all levels & dimensions on site prior to site works commencing & report discrepancies to the Designers.
DO NOT SCALE THIS DRAWING

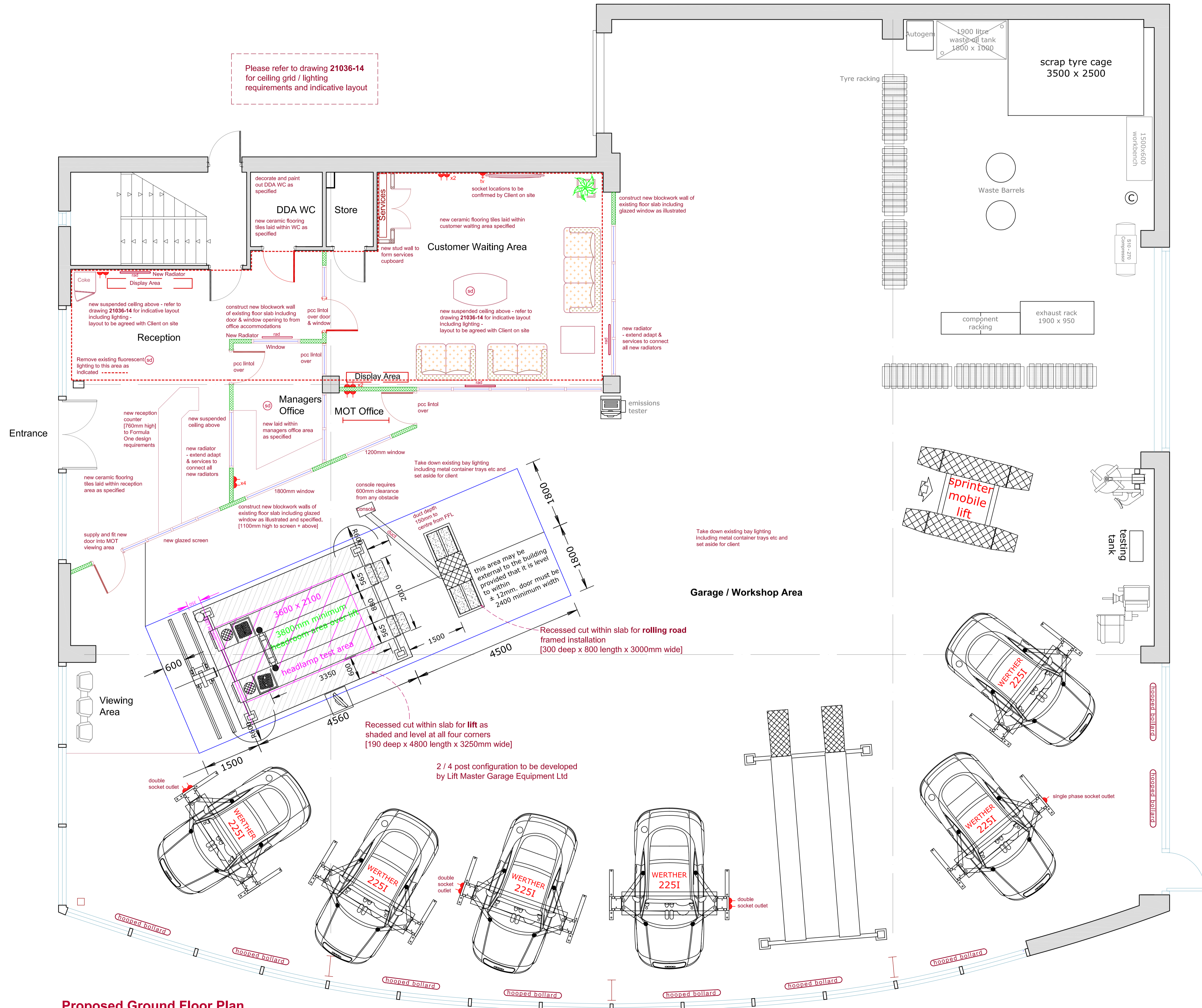

Please refer to drawing 21036-14 for ceiling grid / lighting requirements and indicative layout

Proposed Ground Floor Plan

C	Enhanced Drawing Update	DL	04.01.10
B	Scheme Drawing Enhanced [Spec]	DL	21.12.09
A	Equipment Updates	DL	17.12.09
rev	description	by	date
Project:	F1 Autocentre Fit Out - CRAWLEY Unit 10, Denvale Trading Park, Haslett Ave. RH10 1SS		
Client:	F1 Autocentres		
Title:	Proposed Ground Floor Plan		
Scale:	1:100 @ A3		
Date:	November 2009		
Drawn:	DWL		
Dwg N°:	21036-11C		



ARCHITECTURE INTERIOR PROJECT CDM BUILDING
DESIGN MANAGEMENT CO-ORDINATOR CONSULTANCY

JENKINS DESIGN SERVICES LTD
254 HOUGHTON STREET, BURY,
LANSHIRE, BL9 9JTA
TEL: 0161 254 7872
E: TEAM@JENKINSDESIGN.CO.UK



© This Drawing & Design is the copyright of Jenkins Design Services Ltd and should not be reproduced without written consent.
Contractors are to check all levels & dimensions on site prior to site works commencing & report discrepancies to the Designers.
DO NOT SCALE THIS DRAWING

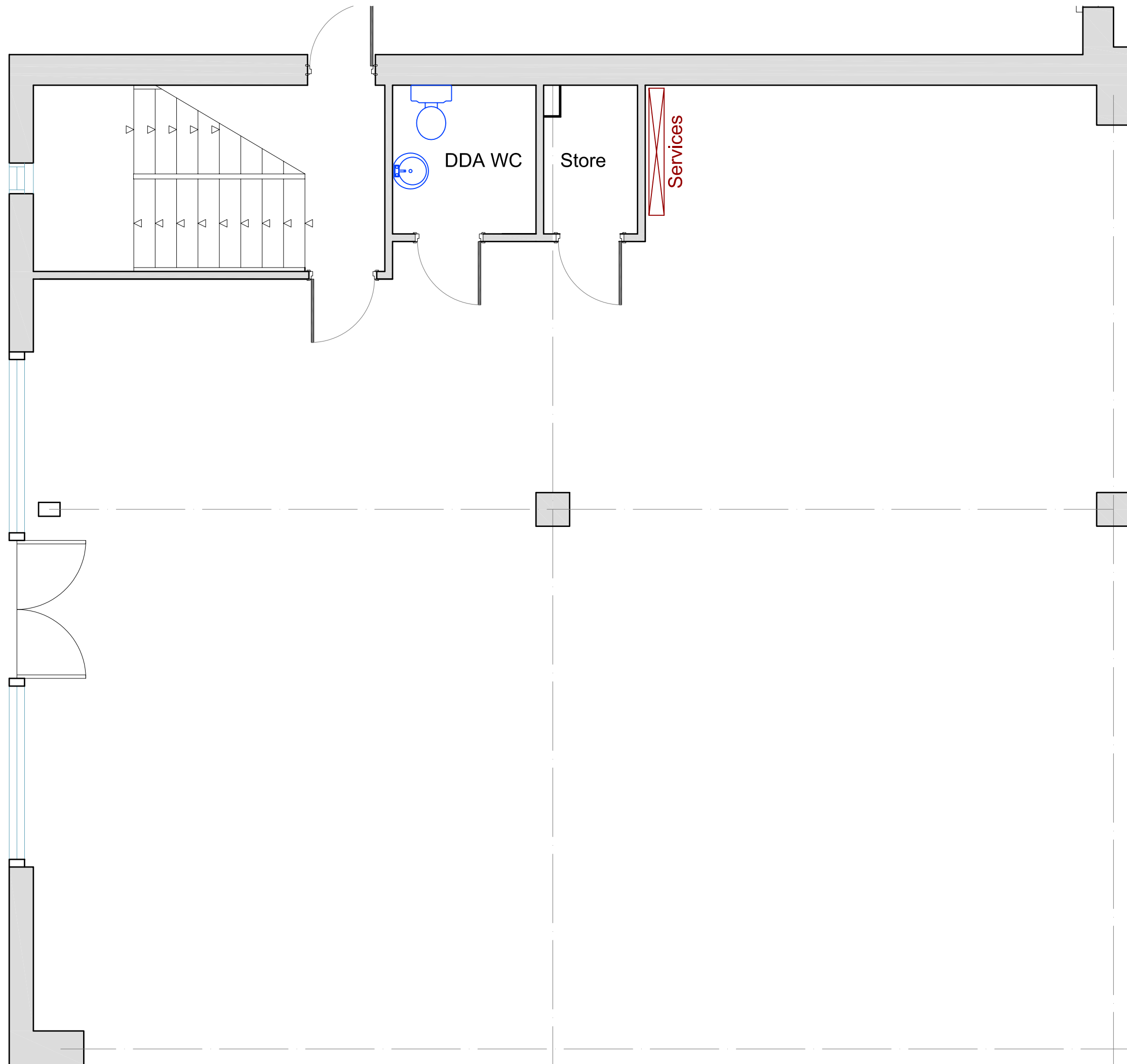

	rev	description	by	date
Project:		F1 Autocentre Fit Out - CRAWLEY Unit 10, Denvale Trading Park, Haslett Ave. RH10 1SS		
Client:		F1 Autocentres		
Title:		Existing Ground Floor Plan - Entrance / Accommodation		
Scale:		1:50 @ A3		
Date:		November 2009		
Drawn:		DWL		
Dwg N°:		21036-02		



ARCHITECTURE INTERIOR PROJECT CDM BUILDING
DESIGN MANAGEMENT CO-ORDINATOR CONSULTANCY

JENKINS DESIGN SERVICES LTD
24 HOUGHTON STREET, BURY,
LANCASHIRE, BL9 7DT
E: TEAM@JENKINSDESIGN.CO.UK



© This Drawing & Design is the copyright of Jenkins Design Services Ltd and should not be reproduced without written consent.
Contractors are to check all levels & dimensions on site prior to site works commencing & report discrepancies to the Designers.
DO NOT SCALE THIS DRAWING

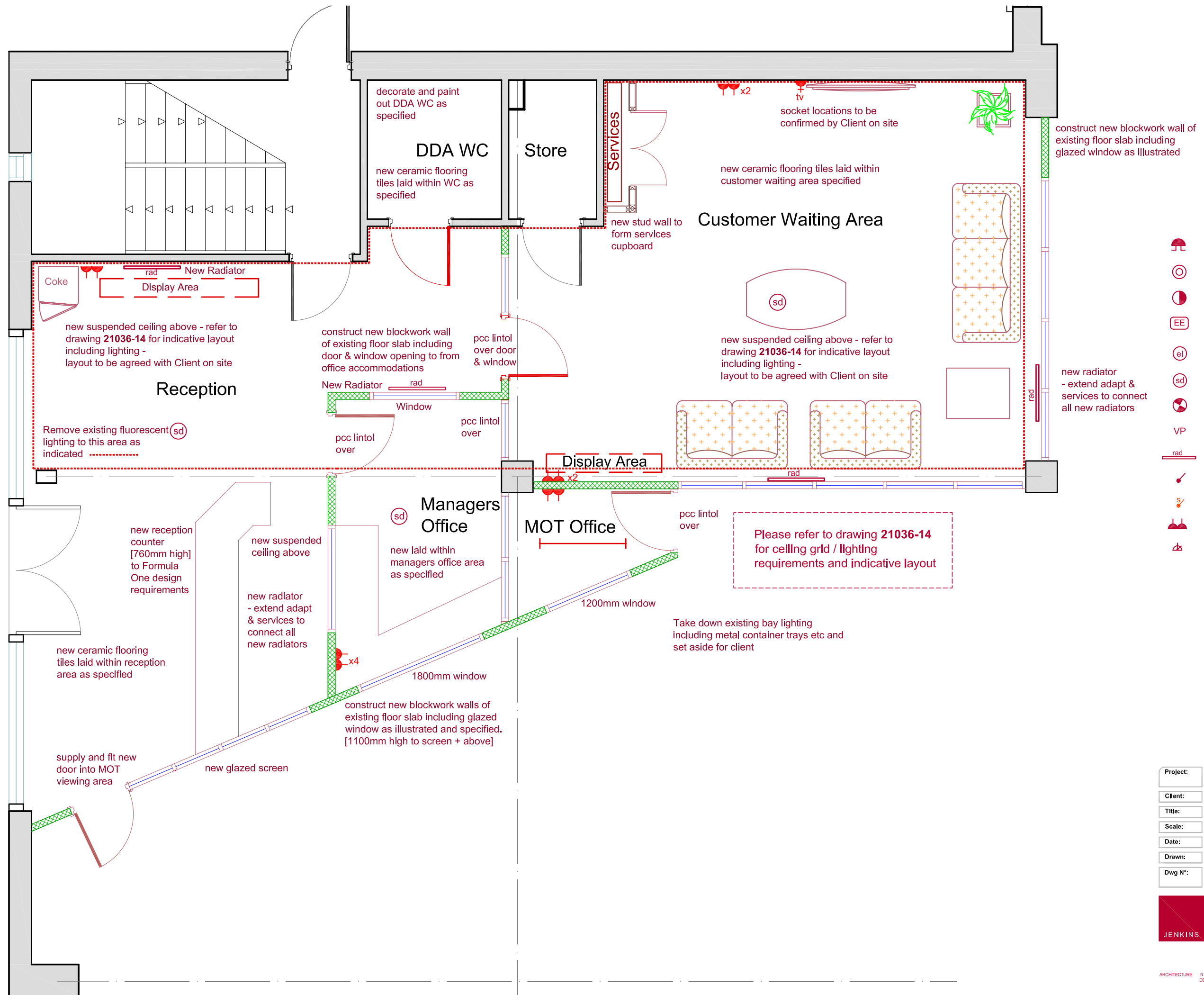

LEGEND

- Fire Alarm Sounder [audible throughout premises]
- Fire Alarm Call Point
- Self closing 30 min Fire Door to BS 748
- Illuminated EXIT Sign
- Emergency Lighting
- Smoke Detector
- Extractor Fan
- Vision Panel
- Radiator
- Light Switch
- Isolated Spur
- Double Switched Socket Outlet
- Single socket outlet beneath worktop with switched spur above worktop

B	Enhanced Drawing Update	DL	04.01.10
A	Scheme Drawing Enhanced (Spec)	DL	21.12.09
rev	description	by	date

Project:	F1 Autocentre Fit Out - CRAWLEY Unit 10, Denvale Trading Park, Haslett Ave. RH10 1SS
Client:	F1 Autocentres
Title:	Proposed Ground Floor Plan - Entrance / Accommodation
Scale:	1:50 @ A3
Date:	November 2009
Drawn:	DWL
Dwg N°:	21036-12B







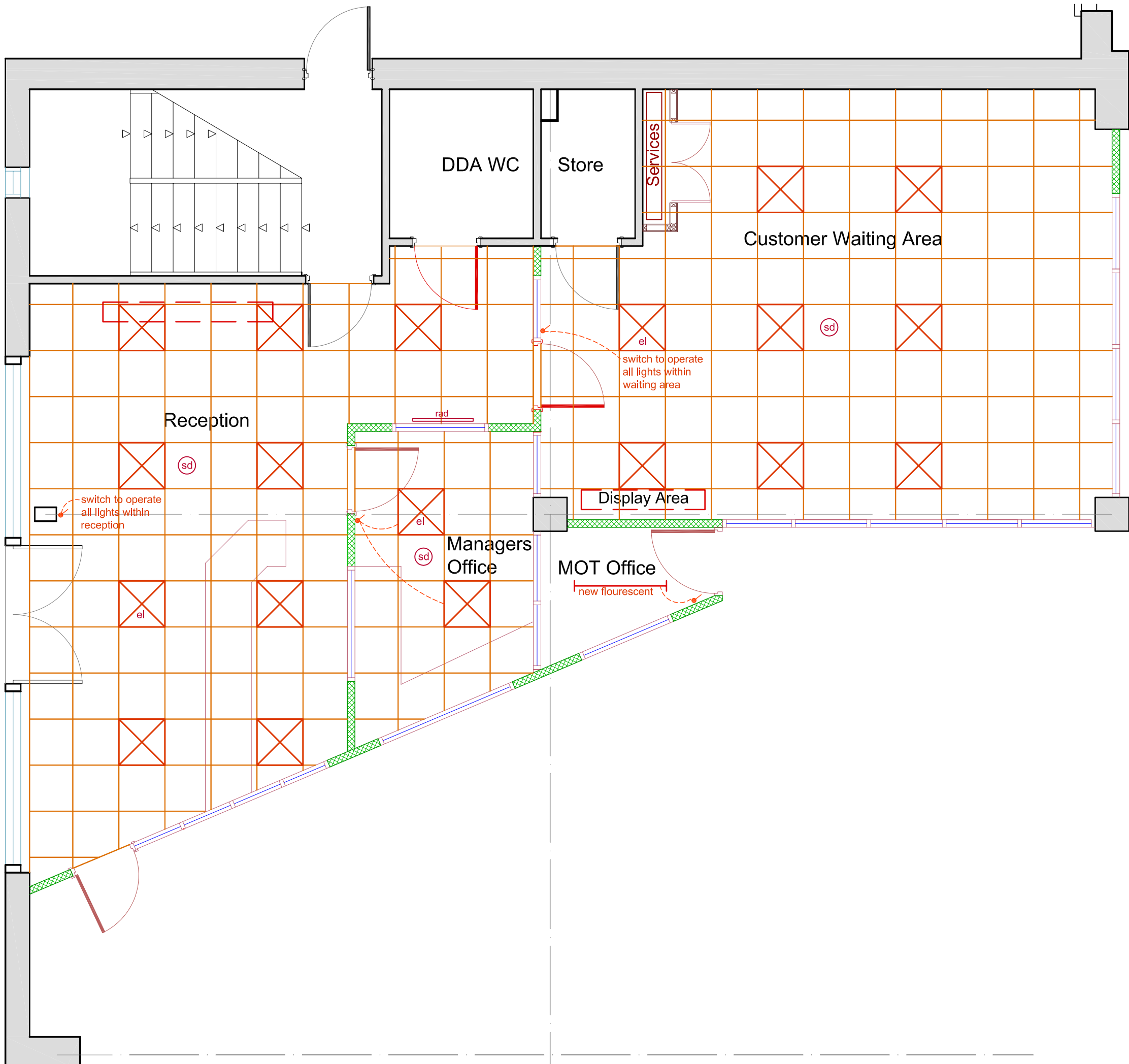









© This Drawing & Design is the copyright of Jenkins Design Services Ltd and should not be reproduced without written consent.
Contractors are to check all levels & dimensions on site prior to site works commencing & report discrepancies to the Designers.
DO NOT SCALE THIS DRAWING



LEGEND

-  Fire Alarm Sounder [audible throughout premises]
-  Fire Alarm Call Point
-  Self closing 30 min Fire Door to BS 748
-  Illuminated EXIT Sign
-  Emergency Lighting
-  Smoke Detector
-  Extractor Fan
-  Vision Panel
-  Radiator
-  Light Switch
-  Isolated Spur
-  Double Switched Socket Outlet
-  Single socket outlet beneath worktop with switched spur above worktop

	rev	description	by	date
Project:		F1 Autocentre Fit Out - CRAWLEY Unit 10, Denvale Trading Park, Haslett Ave. RH10 1SS		
Client:		F1 Autocentres		
Title:		Proposed Ground Floor Plan - Ceiling & Lighting		
Scale:		1:50 @ A3		
Date:		November 2009		
Drawn:		DWL		
Dwg N°:		21036-14		





© This Drawing & Design is the copyright of Jenkins Design Services Ltd and should not be reproduced without written consent.

Contractors are to check all levels & dimensions on site prior to site works commencing & report discrepancies to the Designers.

DO NOT SCALE THIS DRAWING

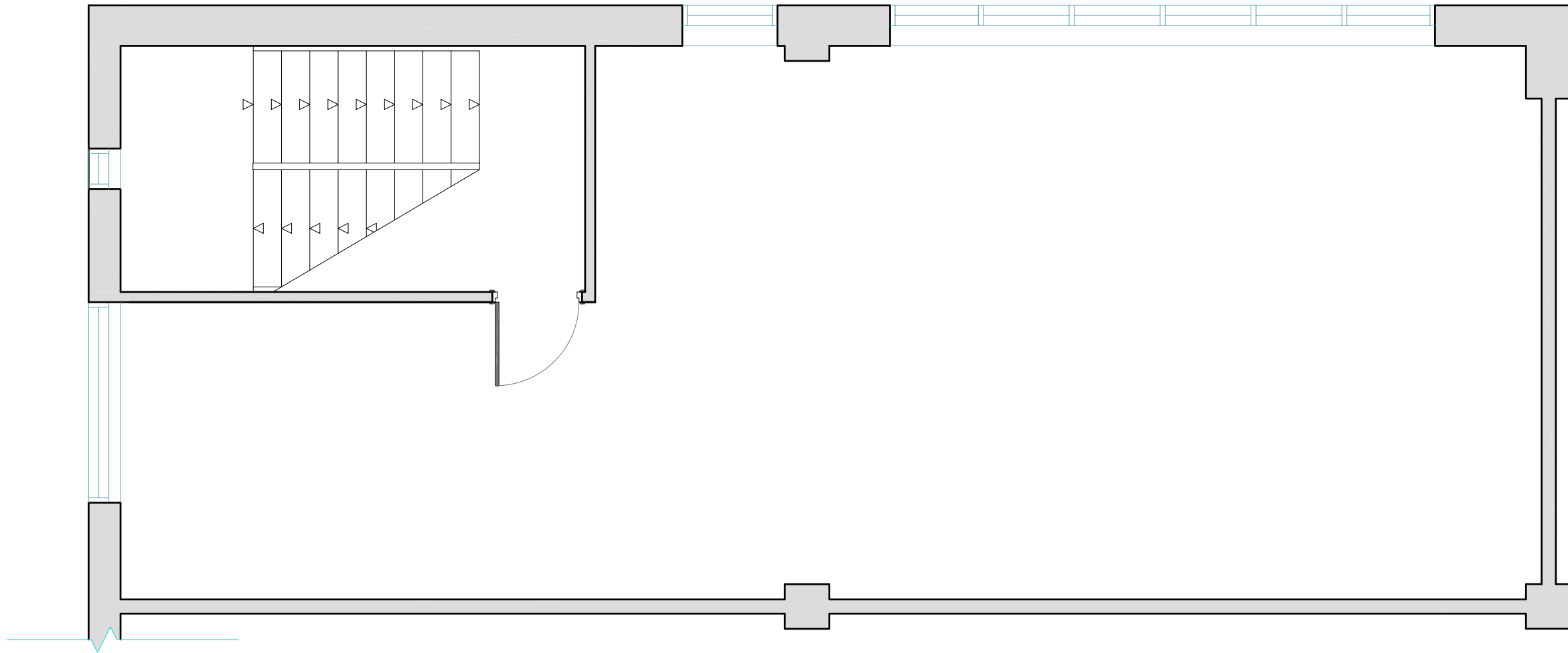

Existing First Floor Plan

	rev	description	by	date
Project:		F1 Autocentre Fit Out - CRAWLEY Unit 10, Denvale Trading Park, Haslett Ave. RH10 1SS		
Client:		F1 Autocentres		
Title:		Existing First Floor Plan		
Scale:		1:50 @ A3		
Date:		November 2009		
Drawn:		DWL		
Dwg N°:		21036-03		



JENKINS DESIGN SERVICES LTD
24 HODGKIN STREET, EARLY
LANCASHIRE BUSINESS PARK, BURNLEY
L1 8JZ
E: TEAM@JENKINS-DESIGN.CO.UK

ARCHITECTURE INTERIOR PROJECT CDM BUILDING
DESIGN MANAGEMENT CO-ORDINATOR CONSULTANCY















© This Drawing & Design is the copyright of Jenkins Design Services Ltd and should not be reproduced without written consent.

Contractors are to check all levels & dimensions on site prior to site works commencing & report discrepancies to the Designers.

DO NOT SCALE THIS DRAWING

LEGEND

-  Fire Alarm Sounder [audible throughout premises]
-  Fire Alarm Call Point
-  Self closing 30 min Fire Door to BS 748
-  Illuminated EXIT Sign
-  Emergency Lighting
-  Smoke Detector
-  Extractor Fan
-  Vision Panel
-  Radiator
-  Light Switch
-  Isolated Spur
-  Double Switched Socket Outlet
-  Single socket outlet beneath worktop with switched spur above worktop

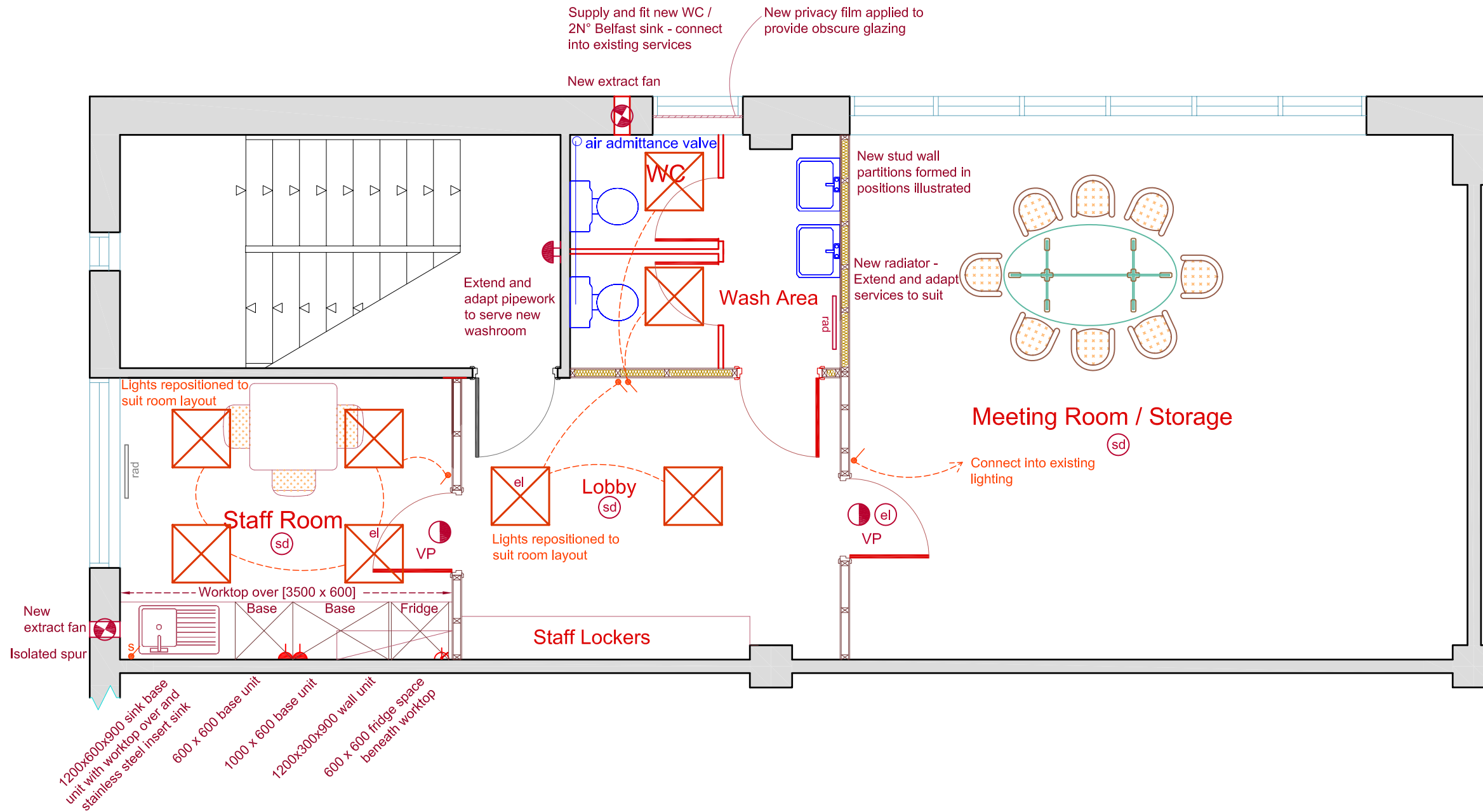

Proposed First Floor Plan

B	Enhanced Drawing Update	DL	04.01.10
A	Scheme Drawing Enhanced [Spec]	DL	21.12.09
rev	description	by	date

Project:	F1 Autocentre Fit Out - CRAWLEY Unit 10, Denvale Trading Park, Haslett Ave. RH10 1SS
Client:	F1 Autocentres
Title:	Proposed First Floor Plan
Scale:	1:50 @ A3
Date:	November 2009
Drawn:	DWL
Dwg N°:	21036-13B



1:10
Scale Bar

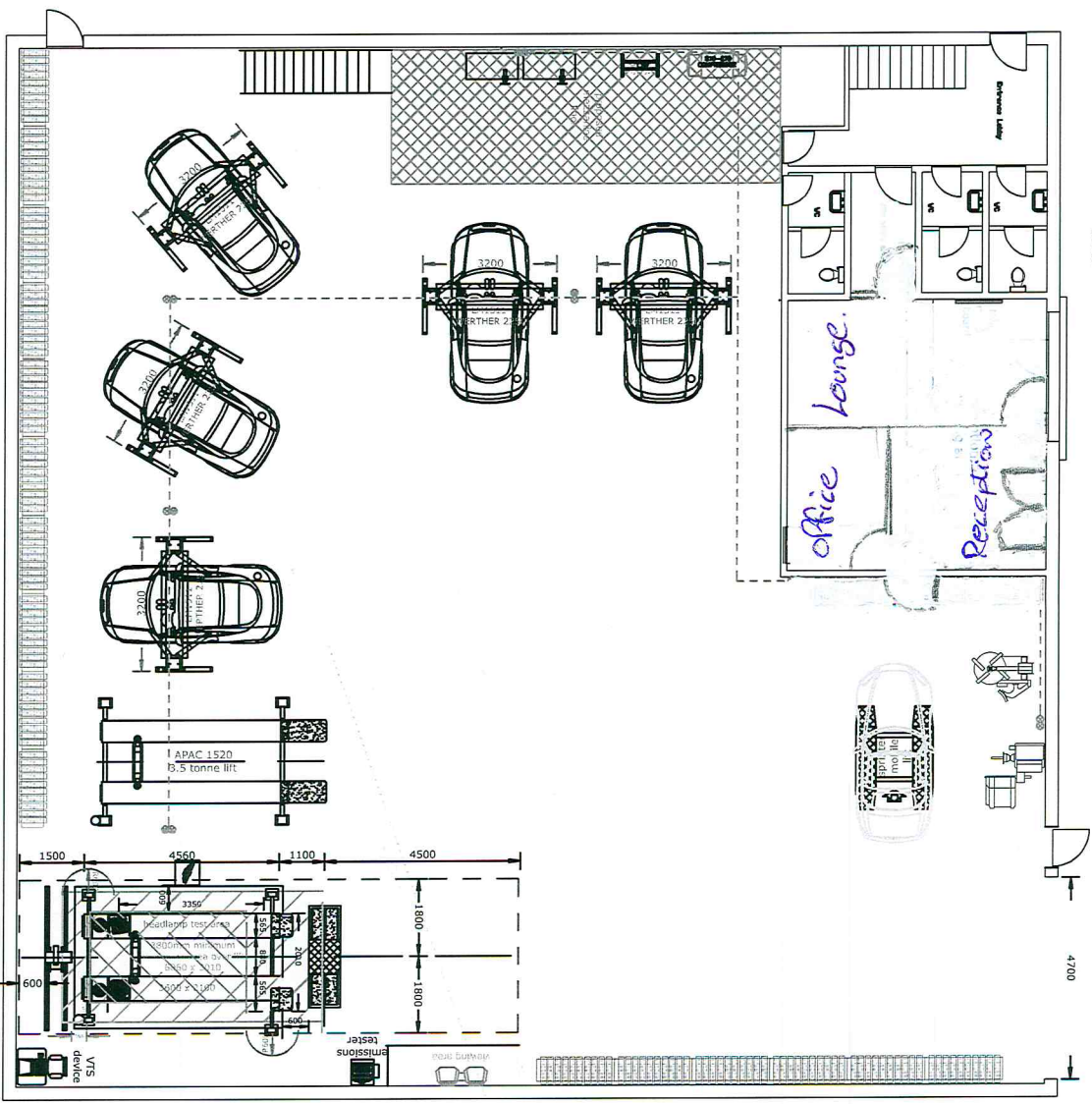

Liftmaster Garage Equipment Ltd

Unit 27, Coker Stream Rd
Mill Lane Ind Est
Hampshire

RG24 2QA
LIFTMASTER GARAGE EQUIPMENT LTD

Unit 27, Coker Stream Rd
Mill Lane Ind Est
Hampshire
RG24 2QA
LIFTMASTER GARAGE EQUIPMENT LTD
www.liftmasteruk.com
sales@liftmasteruk.com



This drawing should be used for layout guidance only and not used for building or installation work. It is not to be scaled from this drawing. Approval in principle must be obtained from VOSA before starting any work.

The lift must be load tested in accordance with statutory requirements and it is the clients' responsibility to provide a suitable vehicle with a weight certificate or a certified test load. The lift must be used in accordance with the manufacturer's instructions in accordance with Manual Handling Regulations. Any prices quoted are exclusive of building, excavation or electrical works.

CLASS 4 MOT REGULATIONS
3.5m minimum height over lift
min. door size 2.4m w x 2.4m h
NOT notice board in waiting area
2 MOT parking bays to be provided
on site, each 4.5m x 2.5m
min. door height 4.5m
beam state roll in to be 4.2m

LIFTMASTER RTATL4PR CLASS 4 ATL MOT BAY COMPRISING:
APAC 4 tonne 4 post lift with recessed turning plates & 547 play detectors
Liftmaster 2 tonne jacking beam
ATL TL720 roller brake tester with integral weighing device
Liftmaster LHTBA1 headlamp beam tester
ATL I 507 009 A16a pedal application device

PROPOSED CLASS 4 ATL MOT TEST BAY FOR:
FORMULA ONE AUTOCENTRES
CITY INDUSTRIAL PARK SOUTHAMPTON

date: 02/06/11 drawing no: 1020611/C scale: n. t. s

